

FRIGOS



Frigos Premium 2 Drawer
Refrigerated Chef Base
SKU: FGP-CB-52

- ★ 10.4 cu. ft. interior capacity
- ★ Accommodates 18 sixth-size food pans
- ★ Heavy-duty top surface with a capacity of 717 lbs.
- ★ 2 drawers with heavy-duty slides and recessed handles
- ★ Self-closing drawers help reduce energy costs
- ★ 6-inch casters allow users to move the unit around
- ★ All stainless steel interior and exterior construction



Amps	2.3
Capacity (Cu Ft)	10.4
Caster Size (Inch)	6
Certifications	ETL Listed, ETL Sanitation
Color	Silver
Compressor Location	Right Side Mounted
Door Type	Solid
Horsepower (HP)	1/6
KW per 24h	1.87
Number of Drawers	2
Plug Type	Nema 5-15P
Refrigerant	R-134a
Shipping Weight (lbs)	485
Temperature Range	33°F to 41°F
Voltage	115/60/1
Weight (lbs)	441

Introducing the Frigos Premium FGP-CB-52 52" 2 Drawer Refrigerated Chef Base, the ultimate solution to elevate your culinary workspace. With a spacious 10.4 cu ft capacity, this chef base is designed to streamline your kitchen operations and keep your essential ingredients conveniently at your fingertips. The solid door design maintains a consistent temperature range of 33°F to 41°F, ensuring your ingredients remain fresh and ready for your culinary creations.

Constructed with precision and elegance in mind, the Frigos Premium FGP-CB-52 features two generous drawers and a sleek stainless steel exterior, blending practicality with style. The 1/6 HP compressor, conveniently located on the right side, guarantees dependable cooling performance. ETL Listed and ETL Sanitation certifications ensure the highest standards of quality and hygiene, making this chef base an indispensable addition to any kitchen. With 6-inch casters for easy mobility, you can keep your workspace organized and efficient. Elevate your kitchen's functionality and aesthetics with the Frigos Premium FGP-CB-52, and ensure your ingredients are always within reach in a clean and stylish environment.

Item	Width (Inch)	Depth (Inch)	Height (Inch)	Material
Exterior	52	32	26.6	Stainless steel
Interior	40	25.6	16.7	Stainless steel



Kitchen Pro Restaurant Equipment: info@gokpe.com | www.kitchenproequipment.com | T. 1(800)603-0033

Note: Specifications subject to change without notice.

Plan View

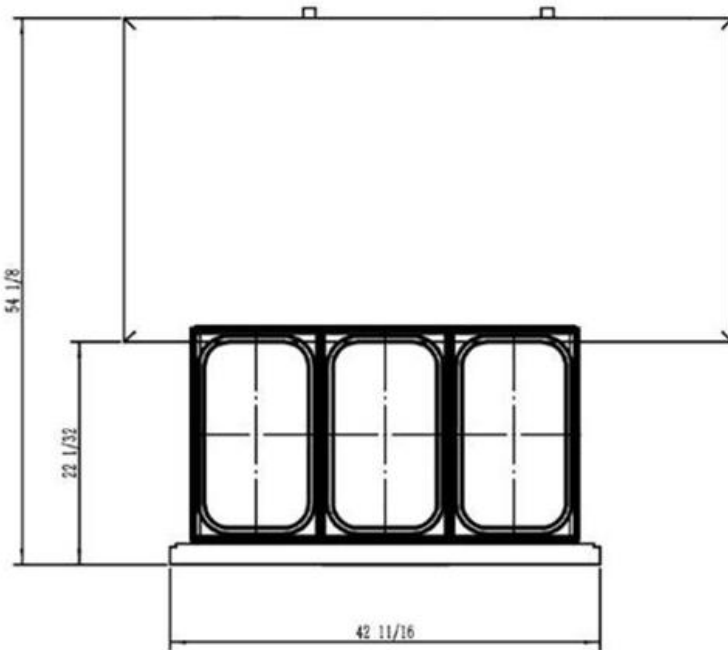
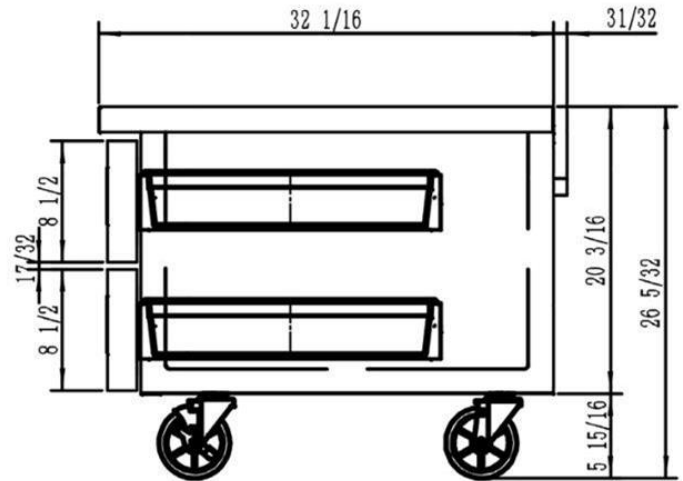
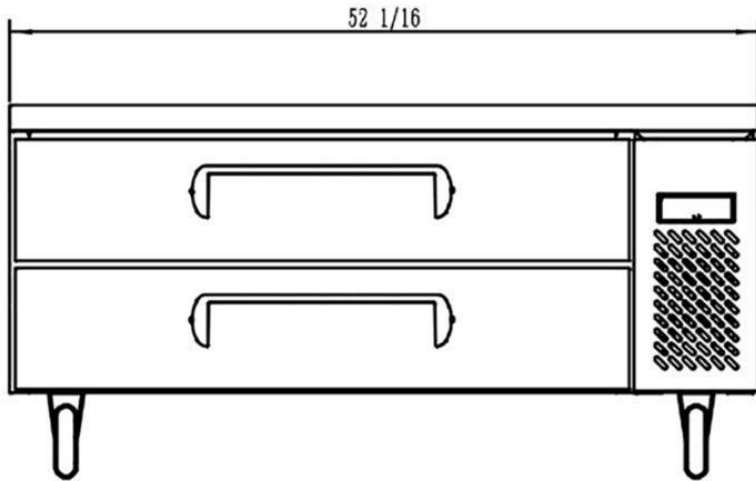

Upgrade your kitchen with the Frigos Premium FGP-CB-52 Chef Base. Featuring a 10.4 cu ft capacity, precise temperature control, and a sleek stainless steel design, it keeps essential ingredients at your fingertips. Crafted with two drawers and a 1/6 HP compressor, it ensures efficiency with style. ETL Listed and ETL Sanitation certifications guarantee top-quality and hygiene standards. With 6-inch casters for mobility, this chef base creates an organized and stylish culinary space.

Warning: This product can expose you to chemicals including lead, which are known to the State of California to cause cancer, birth defects, or other reproductive harm. For more information, go to www.p65warnings.ca.gov.